



Leo in the world

Asia

America

Europe

Oceania



RAIN WATER PUMP

LEO GROUP PUMP(ZHEJIANG) CO.,LTD.

Add: No.1,3rd Street, East Industry Center,317500
Wenling City, Zhejiang P.R.China

Tel: 0086-576-89986360

Fax: 0086-576-89989898

Email:export@leogroup.cn

www.leogroup.cn

LKS-300P

This appliance can be used by children aged from 8 years and above and persons with reduced physical, sensory or mental capabilities or lack of experience and knowledge if they have been given supervision or instruction concerning use of the appliance in a safe way and understand the hazards involved.

Children shall not play with the appliance. Cleaning and user maintenance shall not be made by children without supervision.

Attention!

If the appliance or the supply cord is damaged, it must be repaired by manufacturer, its service agent or qualified person.



Meaning of crossed –out wheeled dustbin:
Do not dispose of electrical appliances as unsorted municipal waste, use separate collection facilities.
Contact you local government for information regarding the collection systems available.

7. Technical Data

Model	LKS-300P
Mains voltage/frequency	220-240 V / 50 Hz
Rated power	300 W
Max. flow	2200 L/H
Max. head	11 m
Max. submersion depth	7 m
Cut - in height	Approx. Min. 285 mm Max. 395 mm
Cut - out height	Approx. Min. 9 mm Max. 14 mm
Min. water depth for operation	1 mm
Power cable	10m H05 RN-F
Max. water temperature	35°C
Insulation class	IPX8
Protection class	F

6. Trouble-Shooting



DANGER! Electric shock!

Risk of injury due to electric shocks. Unplug the pump from the mains before correcting functional problems.

Problem	Possible Cause	Remedy
Pump is running, but doesn't deliver water.	Filter is clogged.	Unplug at the mains and clean the filter.
	Air cannot escape, because the pressure pipe is closed.	Open the pressure pipe (e.g. shut-off valve, delivery units).
	Water level is below minimum water level.	Submerge the pump deeper.
The pump doesn't start or stops suddenly during operation.	The float switch is not connected to the circuit.	Lift the float.
	The length of the float switch cable is too short.	Adjust the length of the float switch cable.
	Power failure.	Check fuses and electrical plug connections.
	Thermal switch has turned the pump off because of overheating.	Unplug at the mains and clean the filter.
Pump is running but the delivery drops suddenly.	Foot/Filter is clogged.	Unplug at the mains and clean the filter. Make sure the water temperature does not exceed 35°C.

If you still have problems, please contact your local service.



Please read these operating instructions carefully and observe the notes given before starting the pump and keep them in a safe place. Use these operating instructions to familiarise yourself with your pump, its proper use and the safety instructions.



For safety reasons, children and young people under the age of 16, as well as people not familiar with these operating instructions, may not use this product. Persons with reduced physical or mental abilities may use the product only if they are supervised or instructed by a responsible person.

➤ Keep these operating instructions in a safe place.

Contents:

- 1. Area of application of your Rain Water Pump 2
- 2. Safety Instructions 2
- 3. Operation 3
- 4. Storage 4
- 5. Maintenance 4
- 6. Trouble-Shooting 5
- 7. Technical Data 6

1. Area of application of your Rain Water Pump

Purpose:

The Rain Water Pump is particularly suited for retrieving rainwater from rain water tanks, e. g the rain water tank, and for watering with a sprinkler. The pump is submerged in the water (to a max. depth of 7 m).

Liquid conveyed:

The Rain Water Pump is suitable for clean to slightly dirty water with a max. particle size of 1 mm. The pump must not be installed in swimming pools; it must be installed and used in accordance with National installation rules.

Attention:



The pump is not intended for long term use (e. g. use for continuous circulation) in a pond. The life span of the pump will be shortened accordingly if used in this way. Continuous operation time shall not exceed two hours for one time. Corrosive (chemicals, cleaning fluids etc...), flammable or explosive liquids (e.g. petrol, paraffin, cellulose thinners); grease, oil, muddy water, salt water and sewage must not be conveyed by the pump. The PH of water must shall be 6.5 - 8.5. Pollution of the liquid could occur due to leakage of lubricants. The water temperature should not exceed 35°C. Do not expose the plug to damp. Protect plug and power cable away from heat, oil and sharp edges. Do not expose the pump to frost. Do not run the pump without water.

2. Safety Instructions



DANGER! Electric shock!

Risk of injury due to electric shocks. Unplug the pump from the mains before correcting functional problems.

Electrical safety:

The pump must not be used when people are in the water. Make sure that the electrical plug and socket connections are fitted in an area which cannot be flooded. And protect power plug from heat, oil and sharp edges. Check out if there is any damage to the pump, especially to the cable and plug. A damaged pump mustn't be used in any way. The mains supply voltage matches the voltage indicated on the pump identification plate (220~240V/50Hz).

The mains power cable must not be used for fastening or transporting the pump. Submersion and withdraw of the pump should be by means of the telescopic pipe. Alternatively, a cord can be secured on the telescopic pipe for submersing, lifting and securing of the Rain Water Pump.

Do not pull out the power cable from the socket as a method of turning the pump off.

Main power cables must not have a smaller cross-section than the rubber-sheathed cables of the designation H05RN-F while the pump without power cable is lighter than 5 kg and the designation H07RN-F while the pump without power cable is heavier than 5 kg. The cable length must be at least 10 m.

Visual check:

Please regularly check the connecting line. If the connecting line of this appliance is damaged, it has to be replaced by the manufacturer or the manufacturer's aftersales service or a similarly qualified person to prevent any hazards.

Before using, always subject the pump (especially the power cable, the float switch cable and the power connections) to a visual inspection.

Do not use a pump which is damaged. In the event of any damage, contact LEO service to check the pump.

Thermal overload protection switch:

If overload, the built-in thermal protection for the motor will switch the pump off. After cooling down, the pump will start again automatically.

3. Operation

Initial Operation:

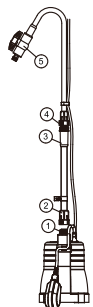

- 1). Pull telescopic pipe from the side of the pump and lock the mating thread (4) and threaded collar (3). Ensure that the washer lies in the mating thread (4) of the telescopic pipe.
- 2). Screw the mating thread (2) onto the pump connector (1).

Ensure that the washer lies in the mating thread (2) of the telescopic pipe.

- 3). Attach mains cable (7) with the attachment clip (6) on the telescopic pipe.
- 4). Attach float switch cable (9) with the attachment clip (8) on the pump.
- 5). The shut-off valve (5) in an operating pump takes on the function of a water tap. Before starting the pump, make sure that shut-off valve (5) partly or completely opened.
- 6). Put the pump into the water.
- 7). Insert the power plug.

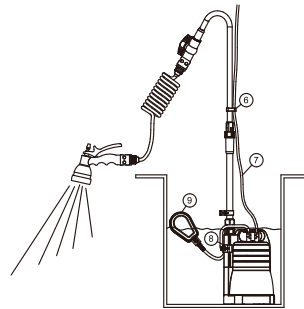

Operation of Float switch:

Automatic mode:

Attach the float switch cable (9) with the attachment clip (8).

Adjust the length of the float switch cable (9) (at least 100 mm as shown in the figure) and the position of the attachment clip (8) can slide up and down. It can also control the switch-on and switch-off level.

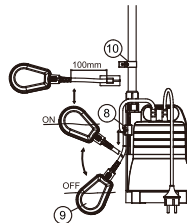

Manual mode:

Attach the float switch cable (9) with the attachment clip (10). (In the condition the minimum water depth can be 1 mm).

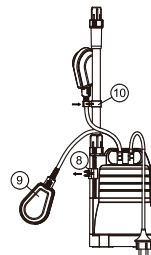

Switch-off height:

If the water level (with the foot fitted) drops below the cut-out. Level (approx.28.5-39.5 cm), the Float Switch automatically switches off the pump (Dry-running protection).

Switch-on height:

If the water level has risen over the cut-in level (approx.9-14 cm), the float switch automatically switches on the pump.

ATTENTION!

The cut-in level and cut-out level depends on the level of the float switch cable length and the position of the attachment clip (2). The level can be adjusted by the end user according to the needs.

4. Storage

Storage:



Store the pump and protect it from freezing.

Disposal:



This product must not be disposed as normal household waste. Dispose in a safe manner in accordance with local environmental regulations.

5.Maintenance

Clean filter:



DANGER! Electric shock!

Risk of injury due to electric shocks.

Unplug the pump from the mains before correcting functional problems.

After pumping slightly dirty water, the filter should be cleaned.

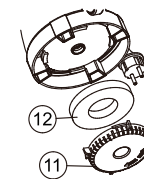

- 1). Turning suction foot (5) 1/4 to the left and remove (bayonet lock).
- 2). Remove (6) filter and clean under running water.
- 3). Re-install filter (6) in the opposite sequence.